

Futtertyp / Chucktype: **N-12**
 Hersteller / Maker: **Kitagawa**
 Nutbreite / Slot width: **18 mm**
 Verzahnung / Serration: **1,5x60°**

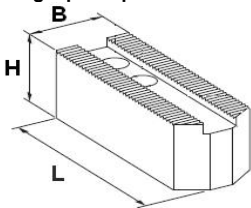

Angespitzt / pointed



Weiche Aufsatzbacken / Soft Top Jaws				Satz = 3 Stück / Set = 3 pieces	
L	B	H	kg	article no.	
145	50	50	6.90	KSJ-12L-145-P	

Flach / Flat

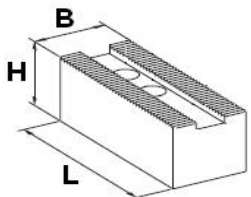

Weiche Aufsatzbacken / Soft Top Jaws				Satz = 3 Stück / Set = 3 pieces	
L	B	H	kg	article no.	
130	50	50	6.30	KSJ-12-F	
130	50	80	9.90	KSJ-12H-80-F	
130	50	100	13.20	KSJ-12H-100-F	
130	50	120	15.45	KSJ-12H-120-F	
130	50	140	18.60	KSJ-12H-140-F	

Gehärtete umkehrbare Stufenbacken / Hard top reversible jaws step type					Satz = 3 Stück / Set = 3 pieces	
L	B	H	T	kg	article no.	
97.5	50	55	20	3.75	HB12B1	

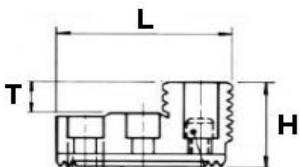

Gehärtete Greiferbacken / Hard top gripper jaws					Satz = 3 Stück / Set = 3 pieces	
L	B	H	Spannbereich / gripping range	kg	article no.	
120	50	49	50-100 mm	5.30	KGJ-12-5010	
102	50	49	100-150 mm	5.00	KGJ-12-1015	
90	60	65	150-200 mm	3.70	KGJ-12-1520	
115	60	65	200-300 mm	5.80	KGJ-12-2030	

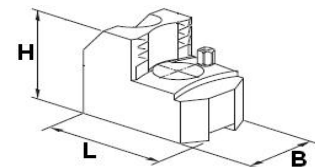

Gehärtete Greiferbacken für kleine Durchmesser / Hard top gripper jaws for small diameters					Satz = 3 Stück / Set = 3 pieces	
L	B	H	Spannbereich / gripping range	kg	article no.	
124	45	59	5-30 mm	4.30	KGJ-12-0530	
112	45	57	30-50 mm	4.50	KGJ-12-3050	

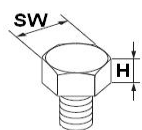
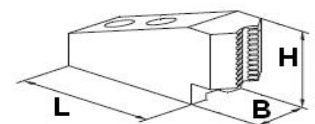

Auflagebolzen M10/8 / Screws for gripper jaws M10/8				Satz = 3 Stück / Set = 3 pieces	
H	SW		kg	article no.	
5	17	für KGJ-12-5010/1015	0.05	KWS-510	
10	17	für KGJ-12-5010/1015	0.08	KWS-1010	
15	17	für KGJ-12-5010/1015	0.11	KWS-1510	
20	17	für KGJ-12-5010/1015	0.13	KWS-2010	
5	13		0.03	KWS-58	
10	13		0.05	KWS-108	
15	13		0.07	KWS-158	
20	13		0.08	KWS-208	

Doppelte Nutensteine passend für N-12 / Double T-Nuts for N-12		Satz = 3 Stück / Set = 3 pieces	
		kg	article no.
		0.44	TNS-B12

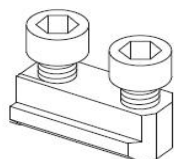

KITAGAWA EUROPE DISTRIBUTORS



AUSTRIA	BELGIUM	CZECH REPUBLIC	DENMARK
Kitagawa Europe GmbH	Bucci Industries	Kitagawa Europe	Tool Part
Tel: + 49 210 212 378 00	Tel: + 32 496 10 10 90	Tel: + 420 603 856 122	Tel: + 45 76 30 12 04
Fax: + 49 210 212 378 69	Fax: + 32 81 45 02 82	Fax: + 420 549 273 246	Fax: + 45 40 33 63 37
email: info@kitagawaeurope.com	a.germentier@bucci-industries.be	imichal.prokes@kitagawaeurope.de	email: info@tool-part.de
Web: www.kitagawaeurope.de	Web: www.iemca.fr	Web: www.kitagawaeurope.de	Web: www.tool-part.dk
EASTERN EUROPE	FINLAND	FRANCE	GERMANY
Kitagawa Europe GmbH	Oy Industrial trading Helsinki	Bucci Industries France	Kitagawa Europe GmbH
Tel: + 49 210 212 378 00	Tel: + 358 500 452 711	Tel: + 33 4 50 89 69 57	Tel: + 49 210 212 378 00
Fax: + 49 210 212 378 69	Fax: + 358 9455 92 306	Fax: + 33 4 50 89 61 35	Fax: + 49 210 212 378 69
email: info@kitagawaeurope.com	email: matti.valakari@ith.fi	email: commercial@iemca.fr	email: info@kitagawaeurope.com
Web: www.kitagawaeurope.de	Web: www.ith.fi	Web: www.iemca.fr	Web: www.kitagawaeurope.de
GREECE	INDIA	ISRAEL	ITALY
Kitagawa Europe GmbH	Kitagawa India Pvt Ltd	Arnold Trading Co Ltd	GIMA Technology S.R.L
Tel: + 49 210 212 378 00	Tel: +91 20 6500 5981	Tel: + 972 3558 1313	Tel: + 39 03312 19170
Fax: + 49 210 212 378 69	Fax: +91 20 2615 0588	Fax: + 972 3558 1317	Fax: + 39 03312 18260
email: info@kitagawaeurope.com	email: sales@kitagawaindia.com	email: info@arnold.il	email: info@gi-ma.it
Web: www.kitagawaeurope.de	Web: www.kitagawaindia.com	Web:	Web: www.gi-ma.it
NETHERLANDS	NORWAY	POLAND	PORTUGAL
Proger Spantechiek BV	Oberg Verktoy AS	Kitagawa Europe	F.Reis
Tel: + 31 (0) 252 52 45 44	Tel: + 47 35 50 54 40	Tel: + 48 32 749 59 18	Tel: + 351 227 878 700
Fax: + 31 (0) 252 51 71 22	Fax: + 47 35 50 54 45	Fax: + 48 32 749 59 18	Fax: + 351 227 878 709
email: info@proger.nl	email: post@obergverktoy.no	Lukasz.tomanek@kitagawaeurope.de	email: geral@freis.pt
Web: www.proger.nl	Web: www.obergverktoy.no	Web: www.kitagawaeurope.com	Web:
RUSSIA	SOUTH AFRICA	SPAIN	SWEDEN
CJSC ST GROUP	Feedback Systems	Talleres de Guernica	Chuckcenter AB
Tel: + 7 495 363-36-28	Tel: + 27 11 708 0510	Tel: + 34 94625 0500	Tel: + 46 431 44 80 65
Fax: + 7 495 363-36-28	Fax: + 27 11 708 0844	Fax: + 34 94625 5351	Fax: + 46 431 164 95
email: info@s-t-group.com	email: feedback@pix.co.za	email: tddeg@grupotdg.com	email: info@chuckcenter.se
Web: www.s-t-group.com	Web:	Web: www.grupotdg.com	Web: www.chuckcenter.se
SWITZERLAND	TURKEY	UK & IRELAND	UKRAINE
Intool AG	Tandem Takim Tezgahlari	1st Machine Tool Accessories	APM Group Service
Tel: + 41 (0) 41 748 07 11	Tel: + 90 216 313 14 13	Tel: + 44 (0) 1725 512517	Tel: + 380 044 331-34-12
Fax: + 41 (0) 41 748 07 01	Fax: + 90 216 313 14 11	Fax: + 44 (0) 1 725 512529	Fax: + 380 044 331-34-12
email: mail@intool.ch	email: info@tandem.com.tr	email: enquires@1mta.com	email: office@apmgroup.co.ua
Web: www.intool.ch	Web: www.tandem.com.tr	Web: www.1mta.com	Web: www.apmgroup.co.ua