

VISE

Lowest profile Type Steel Vises

VE-N series

VE100N·VE125N
VE160N·VE200N

Wide Space machining created Low-Height Steel Vises with the Yellow Body

- High-rigidity steel body
- Ultra-low height type adopted, offering the maximum machining area
- Firm gripping of work ensured by the high jaws
- Stable clamping force ensured by the mechanical-type enhancement toggle mechanism
- Lift-up reduced to the minimum, offering stable machining accuracy
- Standard parallel specification
Suitable for long-size work and simultaneous machining of multiple workpieces



Operating example

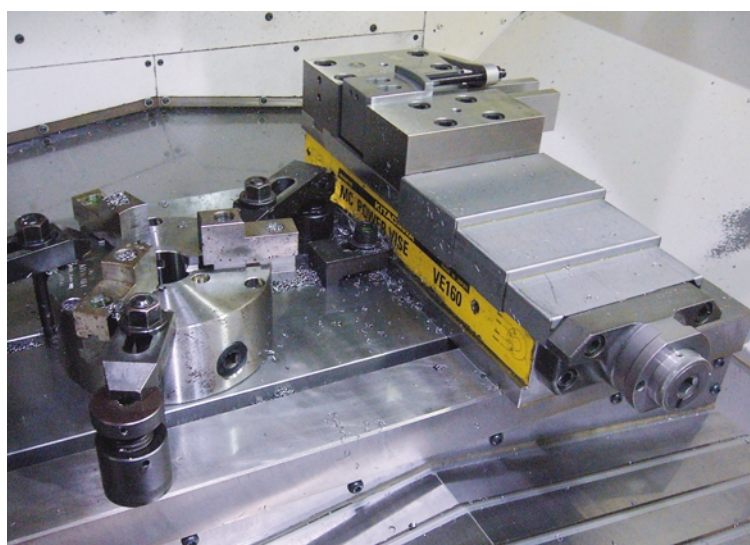

▲With the compact body, a KITAGAWA chuck, etc. can be mounted on a parallel, which makes this vise suitable for high-mix low-volume production.

- **Body Material** : Hardened steel ■ **Jaw Material** : Hardened steel
- **Standard Accessories** : Clamp device assembly (clamp device, T-nut(s), bolt(s), washer(s)), handle, L-shaped hexagonal wrench, C-caps, slide cover
- **Options** : Parallel clamp device, stepped guide block, ratchet handle, extension bar, soft jaws (a set of a moving-side and a fixed-side jaws)

※The guide block can be changed to suit the machine where the vise is mounted. In this case, please contact us.

VE-N

■ Dimensions

■ Clamping Force Table

(Unit : kN)

Range	3	2	1	0
Model VE100N	25	17	9	8
Model VE125N	30	21	12	8
Model VE160N	45	32	20	10
Model VE200N	45	32	20	10

*Zero range means clamp without a step-up mechanism. Clamp force shows an allowable amount.

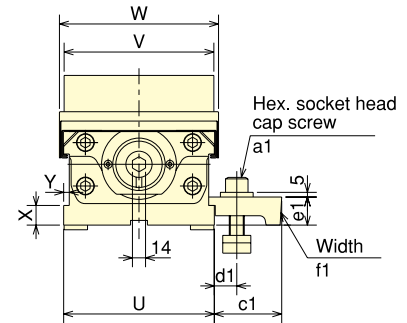
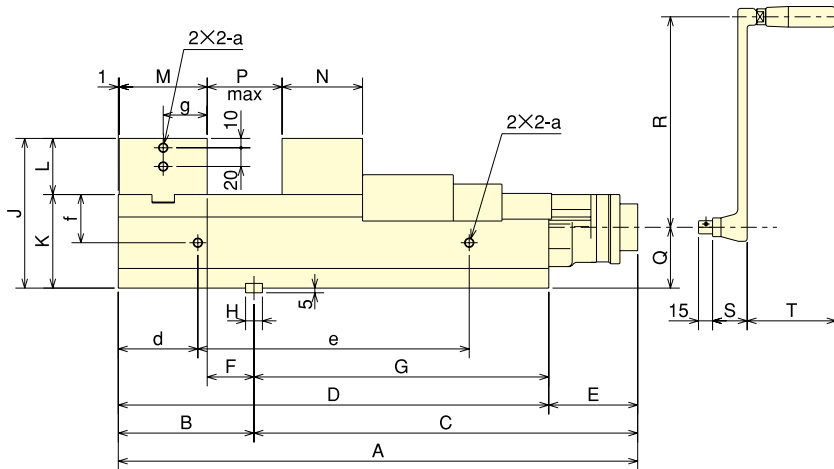
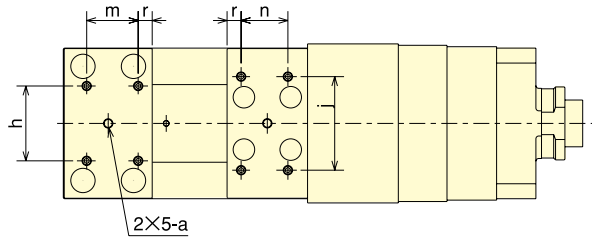

■ Specifications

(Unit : mm)

Model	Model	Jaw height	Jaw stroke	Total height	Work mounting face height	Full width	Full length	Max. clamping force (kN)	Mass (kg)
VE100N	100	40	128	115	75	109	355	25	19
VE125N	125	50	204	135	85	135	455	30	35
VE160N	160	60	274	160	100	170	555	45	62
VE200N	200	70	303	180	110	214	605	45	95

■ Size Table

(Unit : mm)

Model	A	B	C	D	E	F	G	H	J	K	L	M	N	P	Q	R	S	T	U
VE100N	355	112.5	242.5	273	82	38.5	160.5	14	115	75	40	73	64	128	43	180	30	72	103
VE125N	455	145	310	370	85	60	225	18	135	85	50	84	76	204	50	180	30	72	126
VE160N	555	145	410	460	95	50	315	18	160	100	60	94	86	274	65	225	37	95	161
VE200N	605	177	428	510	95	74	333	18	180	110	70	102	98	303	75	225	37	95	202

Model	V	W	X	Y	a	d	e	f	g	h	j	m	n	r	a1	c1	d1	e1	f1
VE100N	100	109	15	5	M 8	90	105	15	36.5	40	70	50	40	10	M12×45	60	14~26	22.5	35
VE125N	125	135	21	6	M10	75	220	44	42	50	80	55	50	10	M16×65	72	15~31	30	45
VE160N	160	170	21	6	M10	85	290	51.5	47	80	100	55	50	15	M16×65	72	15~31	30	45
VE200N	200	214	21	7	M10	115	280	57.5	51	100	150	70	60	15	M16×65	72	15~31	30	45